



November Commission Report

Director's Update

Given by Rebecca Hupp, Airport Director
Boise Airport

NOVEMBER 1, 2023

Phase 4 Parking Garage



- Parking lot has received striping
- Landscaping complete
- Phase 4 East Parking lot will be substantially complete 11/14/23
- Contractor Trailer will move out of the lower commercial lane on 11/17/23

Employee Parking Garage Construction



- Emergency Access Road and entrance/ exits to the garage have been paved
- Fascia panel installation is ongoing
- Sidewalk, curb and gutter on the North side of Rickenbacker/ Airport Way is complete

Electric Boiler for Terminal

- Adding a 1,296 KW electric boiler as the primary heat source for the terminal, greatly reducing the airport's natural gas consumption
 - Existing natural gas-powered boilers will remain as auxiliary and back-up units
- New electric boiler will increase heating capacity for existing and future terminal expansion
- Phase 1 of construction started mid-October
 - Installation of boiler and all associated equipment by end of fall
- Project funded through discretionary grant funding through the FAA BIL-ATP



Airfield Projects

Taxiway Whisky

- Project is substantially complete and both runways are now open

Taxilane N and S Extension

- Final pavement markings are being installed this week

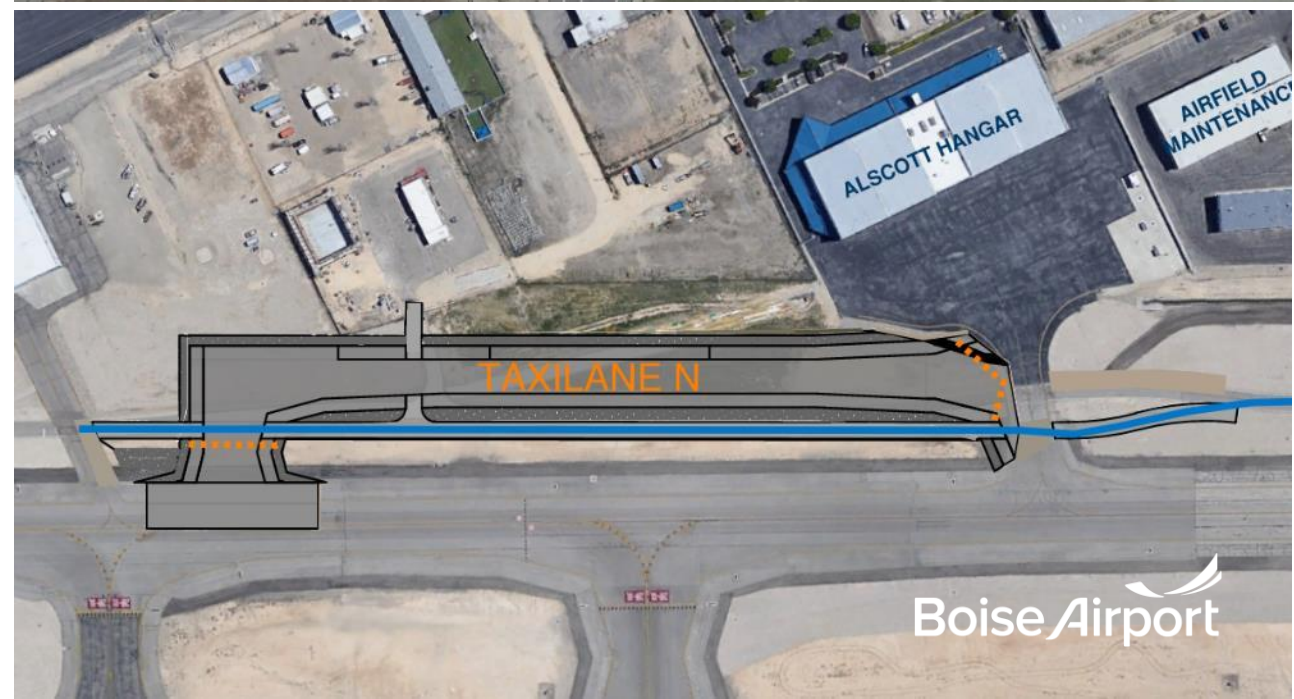
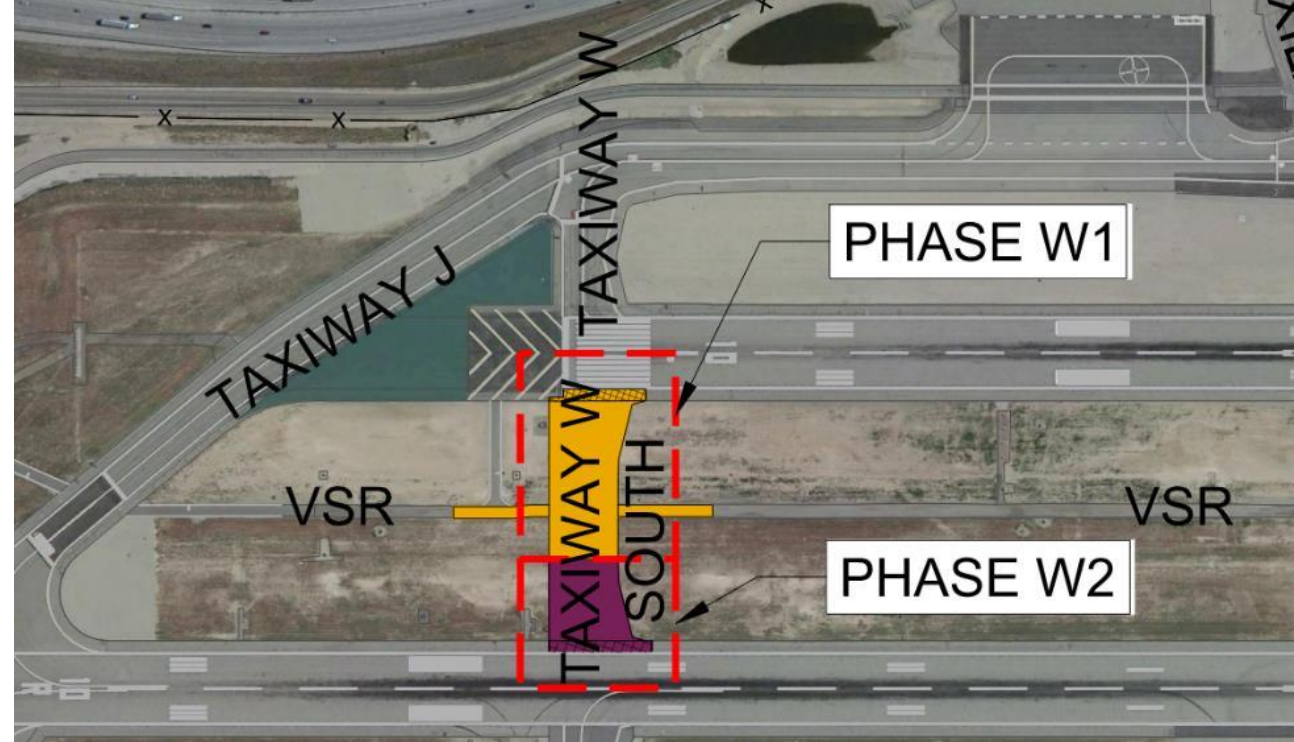

CONRAC

- The Construction Manager/General Contractor (CMGC) agreement with McAlvain was approved by City Council on 10/24
- This project will be split into three packages. Based on subcontractor bids, BOI and McAlvain will work through the Guaranteed Maximum Price (GMP) for each package:
 - Package #1 (Civil site work, demo and upfront utilities): Bid is being validated now
 - Package #2 (Deep foundation, procurement of long-lead items): Bid opening is 11/1
 - Package #3 (Vertical construction, terminal connector walkway): Timing TBD
- Once pricing is validated by the CMGC and BOI, the bid will be sent to City Council for approval

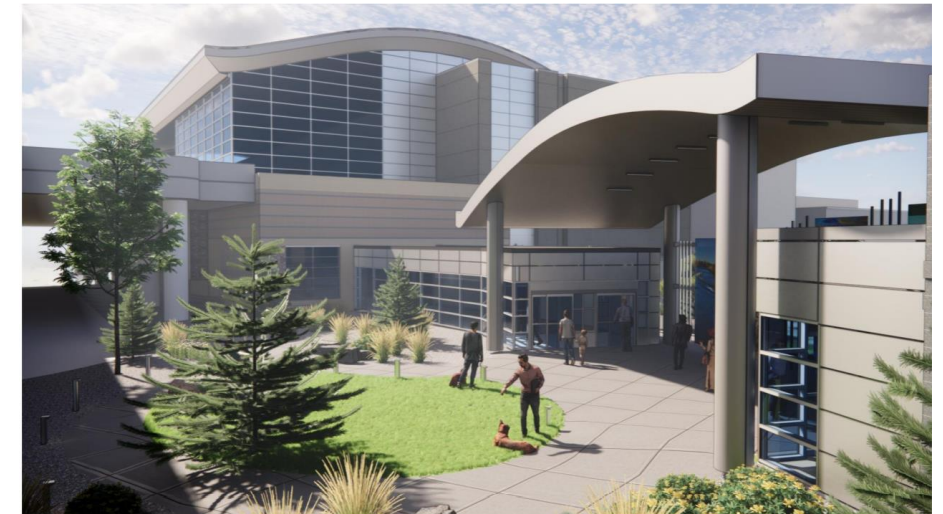

BOI Soon to be Powered by 100% Clean Electricity

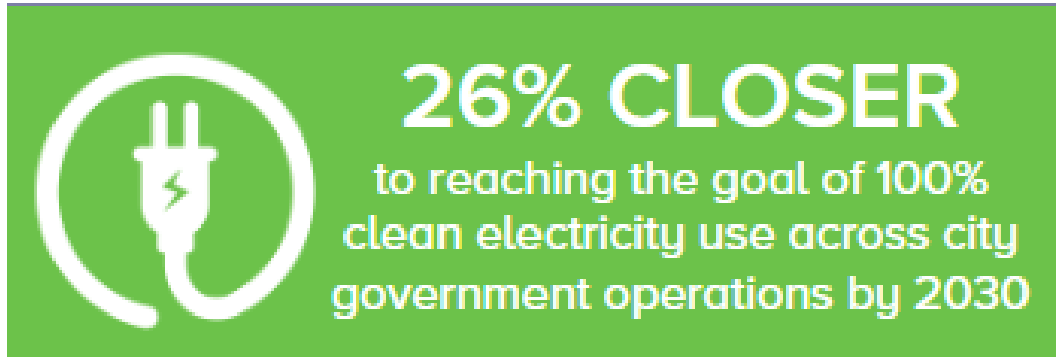

- The City of Boise and Idaho Power announced a plan to transition the Boise Airport and Lander Street Water Renewal Facility to 100% clean electricity by participating in the Clean Energy Your Way program



Sun Country Joining BOI in 2024

- Sun Country announced they will begin 2x weekly service to Minneapolis-St Paul next June
- There will now be nine airline partners serving BOI



Southwest Expands Service

- Southwest's latest schedule announcement included:
 - A new route for the carrier from BOI, Burbank, CA
 - The return of weekend service to Dallas Love Field
 - Increased frequencies to Denver, Las Vegas, and Phoenix



Aircraft Incident

- In the early morning of October 12, a small twin-engine aircraft experienced a mechanical issue while taxiing, resulting in the aircraft rolling into a fence and catching fire
- The pilot safely exited the aircraft and Airport Operations and Boise Fire Department's Aircraft Rescue and Firefighting Apparatus (ARFF) responded
- The fire was suppressed and appropriate hazmat clean-up was completed within 24-hours
- No injuries were reported and there was no impact to airport operations
- Thank you to the entire BOI team for their rapid and thorough response

Concessions Meet and Greet



The graphic is a promotional poster for a 'Boise Airport Concessions Open House'. It features a dark blue background with white and light blue text. At the top left, it says 'Boise Airport' with a logo, followed by 'SAVE THE DATE' in large white letters. To the right is a photograph of the airport terminal. Below this, the main title 'BOISE AIRPORT CONCESSIONS OPEN HOUSE' is written in white, with 'Food & Beverage | Gift & News' underneath. To the right of the title, the time '3-5 PM' is displayed in large white letters, with 'THURSDAY, NOV 2nd, 2023' in smaller white letters below it. At the bottom left, there is a light blue illustration of various food and beverage items like a burger, fries, a drink, and a water bottle. To the right of this illustration, the text reads: 'Come meet potential operators and learn more about airport concessions', 'Boise River Room, Third Floor of the Airport', and 'Please RSVP to Dave Varn by October 30th at dvarn@cityofboise.org and let him know if you would like to host a table with your offerings [not required]. Parking will be validated.'

Boise Airport
SAVE THE DATE

BOISE AIRPORT CONCESSIONS OPEN HOUSE
Food & Beverage | Gift & News

3-5 PM
THURSDAY, NOV 2nd, 2023

Come meet potential operators and learn more about airport concessions

Boise River Room,
Third Floor of the Airport

Please RSVP to Dave Varn by October 30th at dvarn@cityofboise.org and let him know if you would like to host a table with your offerings [not required]. Parking will be validated.

- In preparation for our upcoming Prime Concessionaire RFP that will be issued in January, BOI is holding a meet and greet for local businesses to meet and network with potential concessionaire partners
- Meet and Greet takes place tomorrow, 11/2, from 3-5pm

23-24 Winter Operations Preparations

- Airport Operations held its annual Winter Operations Pre-Season Briefing on October 17
- The local National Weather Service office provided a winter outlook, forecasting a 75-85% chance for a strong El Niño this season, which could mean warmer and drier than normal conditions

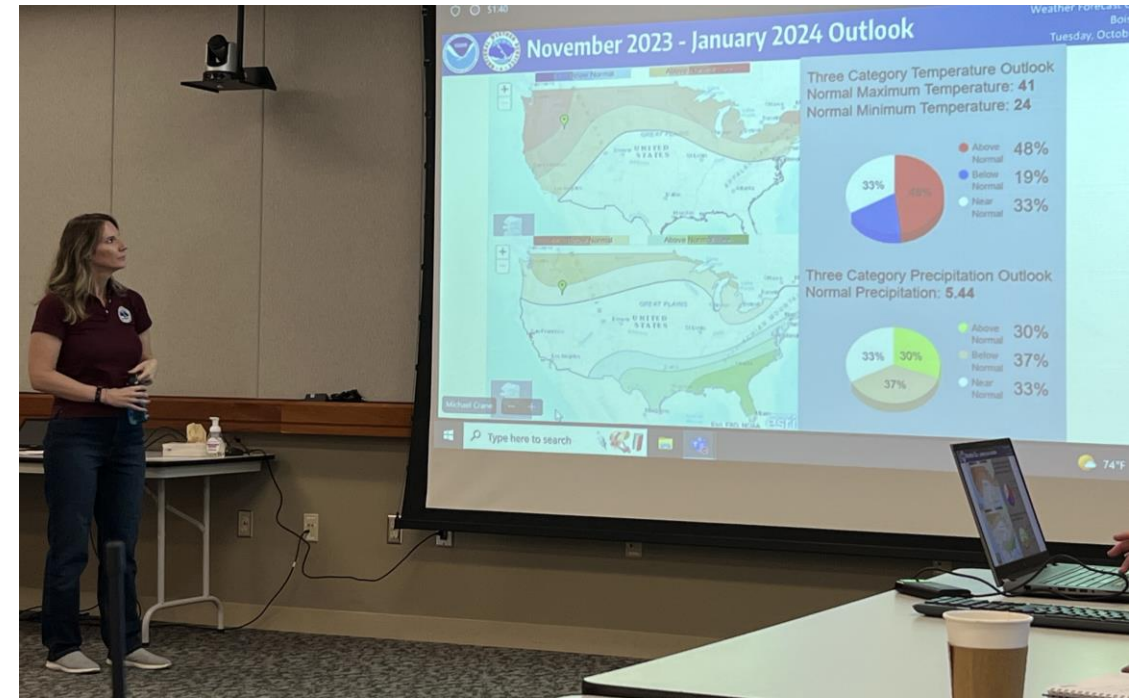

Fuel Farm Rezone Approved

- City of Boise Planning and Zoning Commission approved the rezone of BOI-owned parcels from M-1 (light industrial) to M-2 (heavy industrial) in anticipation of a possible fuel facility
- BoiseFuel LLC, a consortium of airline partners, hopes to construct, own and operate a fuel farm facility at BOI to increase onsite jet fuel capacity
- This rezone is in alignment with Boise City's Comprehensive Plan, BluePrint Boise



New Parking Operator

- Boise-based company, The Car Park, was awarded the 3-year contract and begins management duties today! (November 1st)
- The Car Park also operates BOI's valet parking
- The Boise Airport issued a Request for Proposals this summer to begin the process of selecting an operator for our parking facilities



2023 General Aviation Meeting



- BOI welcomed its GA tenants on 10/28 for a lunch and learn
- Topics included an update from the Idaho National Guard, a reminder about wrong surface landings from Boise Air Traffic Control, construction update from BOI Engineering, an introduction to AirBadge from Security and Credentialing and an overview of general aviation at BOI

Meet Up with the Mayor

- Mayor McLean will be at the airport on Monday, November 13th from 10:30-11:30am for her reoccurring event “Meet Up with the Mayor”
- Director Hupp will accompany her for an informal chat about upcoming plans at the Boise Airport
- The public is invited to attend, and parking will be validated

September Enplanements

Enplanements are flat compared to September 2022

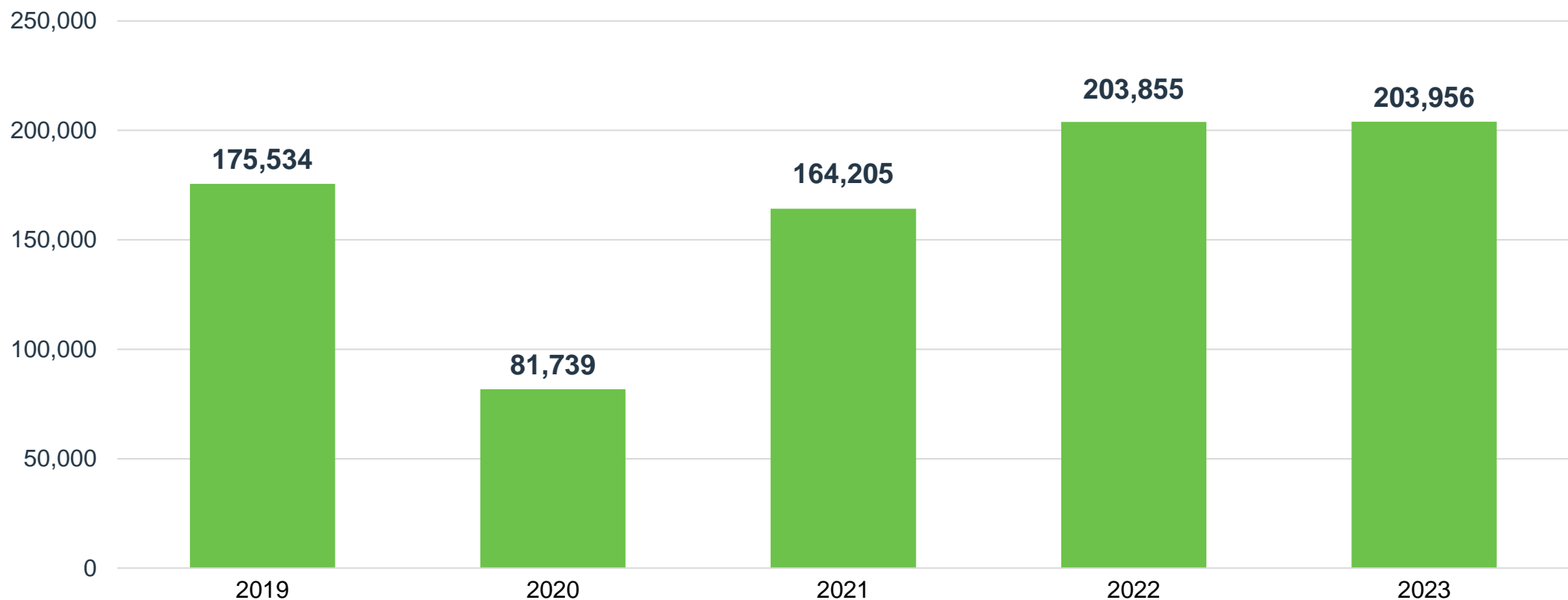

2023 Total Passengers (through September)

Up 7% over 2022

Total Passengers

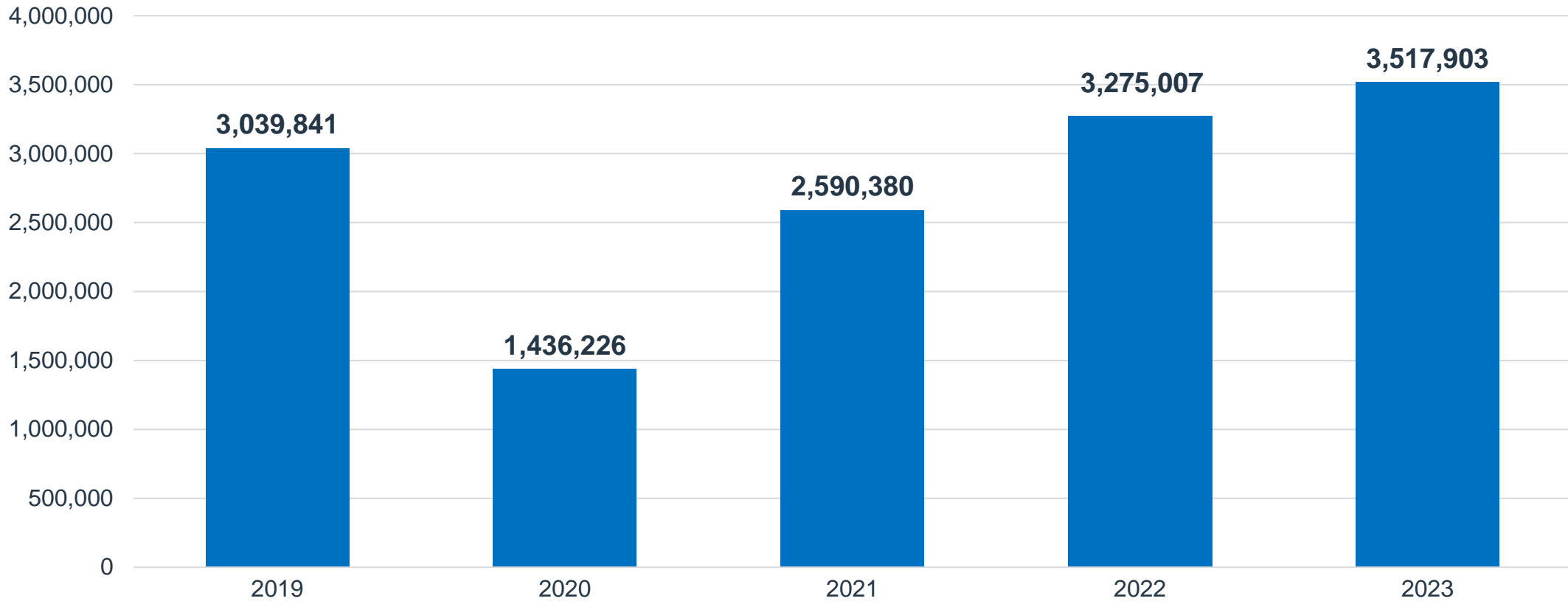

Top 10 Operating Revenue Description	FY 2023	FY 2022	\$ Change	% Change
Parking Lot	\$ 16,536,964	\$ 14,748,135	\$ 1,788,829	12%
Signatory Airline Landing Fees	\$ 8,009,748	\$ 3,592,416	\$ 4,417,332	123%
Rental Car Concession	\$ 6,088,423	\$ 6,235,101	(\$ 146,678)	-2%
Terminal Rent - Airlines	\$ 4,956,467	\$ 3,703,611	\$ 1,252,856	34%
Industrial Land Rent	\$ 4,069,689	\$ 4,000,764	\$ 68,925	2%
Terminal Concessions – Retail	\$ 1,291,932	\$ 1,254,168	\$ 37,764	3%
Landings/Freight	\$ 1,195,201	\$ 894,097	\$ 301,104	34%
Terminal Concessions – Food/Beverage	\$ 1,194,714	\$ 1,314,512	(\$ 119,798)	-9%
Employee Parking Permits	\$ 667,241	\$ 597,418	\$ 69,823	12%
Terminal Rent – Non-Airlines	\$ 577,804	\$ 596,172	(\$ 18,368)	-3%
Total Top 10 Operating Revenue	\$ 44,588,183	\$ 36,936,394	\$ 7,651,789	--
Other Operating Revenue	\$ 4,790,253	\$ 3,670,854	\$ 1,119,399	30%
Total Operating Revenue	\$ 49,378,436	\$ 40,607,248	\$ 8,771,188	22%

Top 10 Operating Expenses Description	FY 2023	FY 2022	\$ Change	% Change
Personnel	\$ 12,820,466	\$ 10,810,734	\$ 2,009,732	19%
Indirect Cost Reimbursement	\$ 4,387,885	\$ 3,778,897	\$ 608,988	16%
Parking Management	\$ 4,183,834	\$ 2,737,039	\$ 1,446,795	53%
Policing Service	\$ 3,308,218	\$ 3,620,276	(\$ 312,058)	-9%
Fire Service	\$ 3,132,037	\$ 3,169,337	(\$ 37,300)	-1%
R/M – Structural/Electrical/Plumbing	\$ 1,241,596	\$ 788,129	\$ 453,467	58%
Power	\$ 1,037,379	\$ 885,295	\$ 152,084	17%
Chemicals	\$ 1,006,856	\$ 377,709	\$ 629,147	167%
R/M – Fleet Management	\$ 641,932	\$ 581,267	\$ 60,665	10%
Minor Equipment	\$ 514,171	\$ 608,326	(\$ 94,155)	-15%
Total Top 10 Operating Expenses	\$ 32,274,373	\$ 27,357,009	--	--
Other Operating Expense	\$ 6,727,862	\$ 7,725,237	(\$ 997,374)	-13%
Total Operating Expense	\$ 39,002,235	\$ 35,082,246	\$ 3,919,989	11%

Top Origination/Destination Markets

Rank	Destination	O&D Pax	O&D Revenue	Average Fare (\$)	Yield (¢)	% Change Since Q2 2022			
						Pax	Rev	Fare	Yield
1	Seattle, WA	91,085	11,088,147	122	31	13	18	4	4
2	Phoenix, AZ (PHX)	57,479	8,550,568	149	20	5	8	3	3
3	Las Vegas, NV	55,986	5,698,009	102	20	35	1	(26)	(26)
4	Los Angeles, CA	45,862	7,228,588	158	23	(16)	(14)	3	3
5	Denver, CO	44,392	8,117,321	183	28	5	12	7	7
6	Portland, OR	41,787	6,502,291	156	45	5	12	7	7
7	Sacramento, CA	40,833	4,977,002	122	28	30	16	(11)	(11)
8	San Diego, CA	40,517	5,857,660	145	19	5	(1)	(6)	(6)
9	Orange County, CA	30,460	3,878,704	127	19	14	10	(3)	(3)
10	Spokane, WA	28,680	3,837,040	134	47	9	12	3	3
11	San Jose, CA	28,537	3,587,453	126	24	31	23	(6)	(6)
12	San Francisco, CA	25,191	3,990,831	158	30	(12)	(5)	9	9
13	Burbank, CA	24,922	2,680,054	108	16	81	68	(7)	(7)
14	Oakland, CA	21,636	2,639,827	122	24	(8)	(5)	3	3
15	Chicago, IL (ORD)	20,699	5,249,680	254	18	12	(2)	(12)	(12)
16	Dallas, TX (DFW)	19,537	5,430,419	278	22	8	3	(5)	(5)
17	Salt Lake City, UT	19,085	3,858,280	202	69	5	9	3	3
18	Minneapolis, MN	15,137	4,131,288	273	24	(2)	10	13	13
19	Atlanta, GA	15,080	4,812,357	319	17	4	1	(3)	(3)
20	Orlando, FL (MCO)	13,151	3,733,134	284	13	(7)	(14)	(7)	(7)
	Total/Average	1,146,640	258,888,164	226	19	8	9	1	(3)

15 of the top 20 markets had increased passengers compared to Q2 2022, with Burbank increasing by the highest percentage

Boise Traffic/Capacity Trends

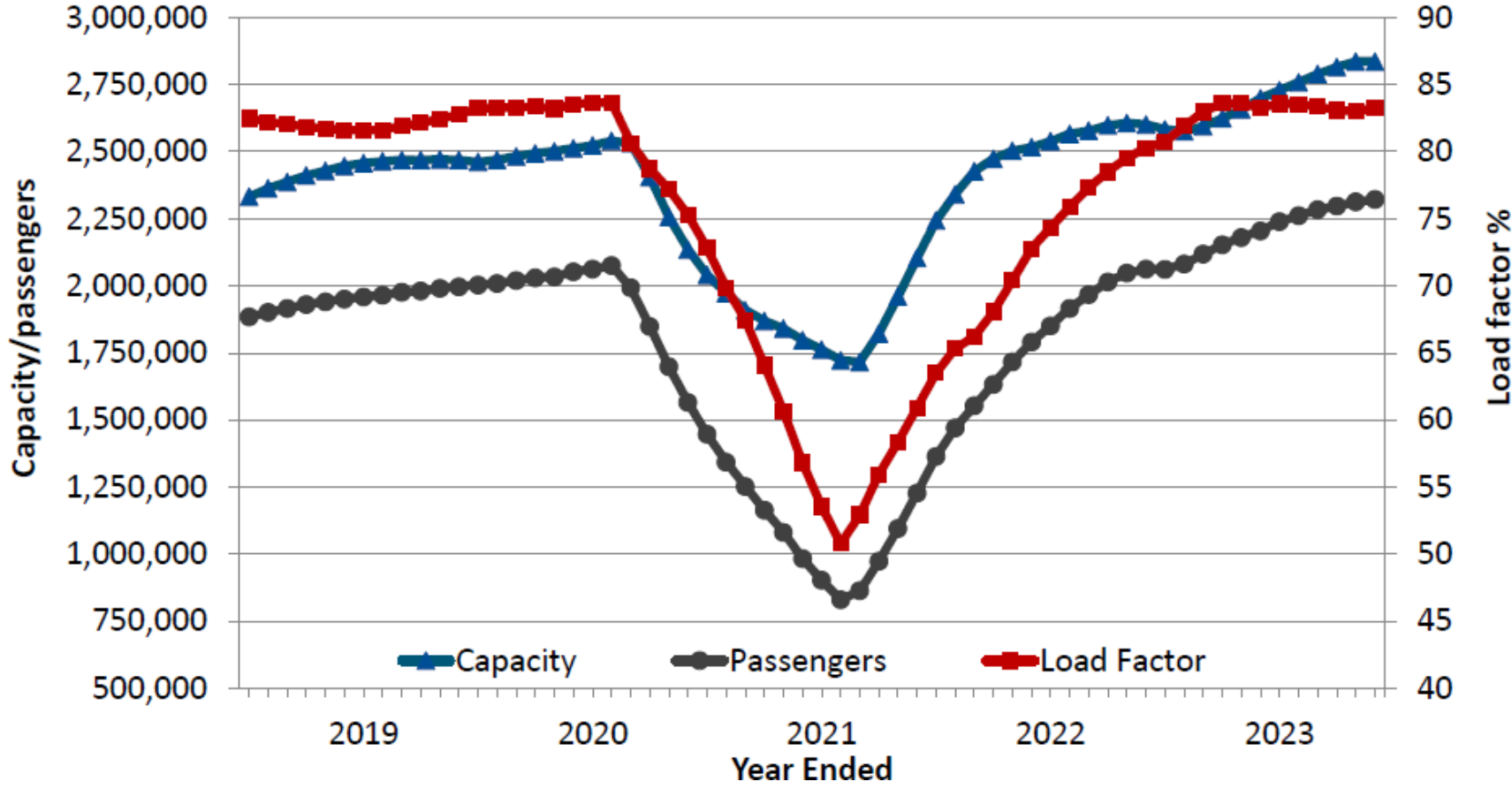

YE June 2023 capacity was up 9%, while passengers were up 13%, leading to a 3% point increase in the average load factor (83%)

Boise Airline Market Share

AS and WN lost 1% point of share each to DL and NK in the latest year-ended period

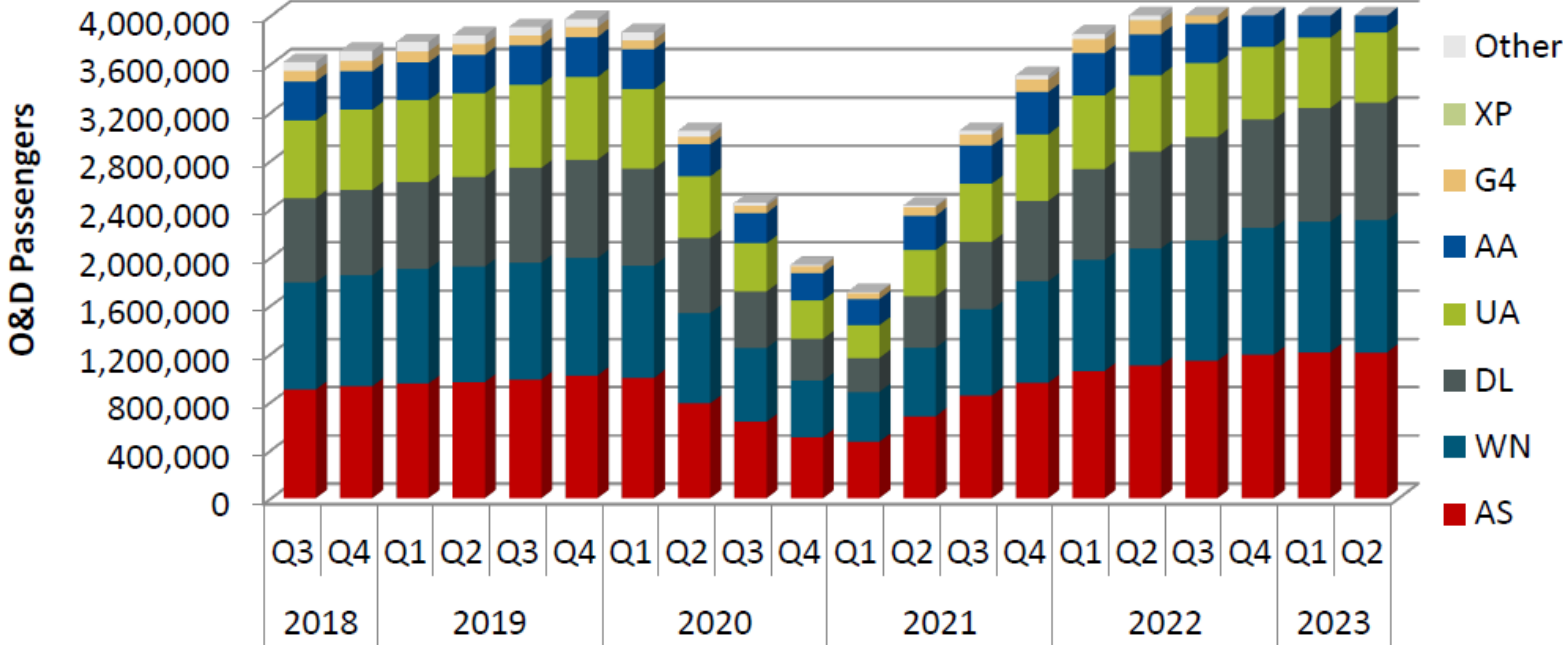

Year	Quarter	Airline Market Share								
		AS	WN	DL	UA	AA	G4	NK	XP	Other
2021	Q3	28%	24%	18%	16%	10%	3%	0%	0%	1%
	Q4	27%	24%	19%	16%	10%	3%	0%	0%	1%
2022	Q1	27%	24%	20%	16%	9%	3%	0%	0%	1%
	Q2	27%	24%	20%	16%	9%	3%	0%	0%	1%
	Q3	28%	24%	21%	15%	8%	3%	0%	0%	1%
	Q4	28%	25%	21%	14%	8%	2%	1%	0%	1%
2023	Q1	28%	25%	21%	13%	8%	2%	1%	1%	1%
	Q2	27%	24%	22%	13%	8%	2%	2%	1%	1%

Boise Forward Looking Schedule

Over the next 6 months, BOI's flights are scheduled to be up 2%, while seats are scheduled to be up 1% compared to the same months in the prior year

Airline	Destination	Year-Over-Year Change %											
		Oct 2023		Nov 2023		Dec 2023		Jan 2024		Feb 2024		Mar 2024	
		Flts	Seats	Flts	Seats	Flts	Seats	Flts	Seats	Flts	Seats	Flts	Seats
Total		1%	3%	3%	2%	2%	(2%)	(2%)	(2%)	(3%)	(2%)	10%	9%

Seats Per Capita Comparison

BOI exceeds all comparison markets except Spokane (GEG), Charleston (CHS) and Reno (RNO) in seats per capita and increased from 3.4 to 3.46 from YE Q1 2023 to YE Q2 2023

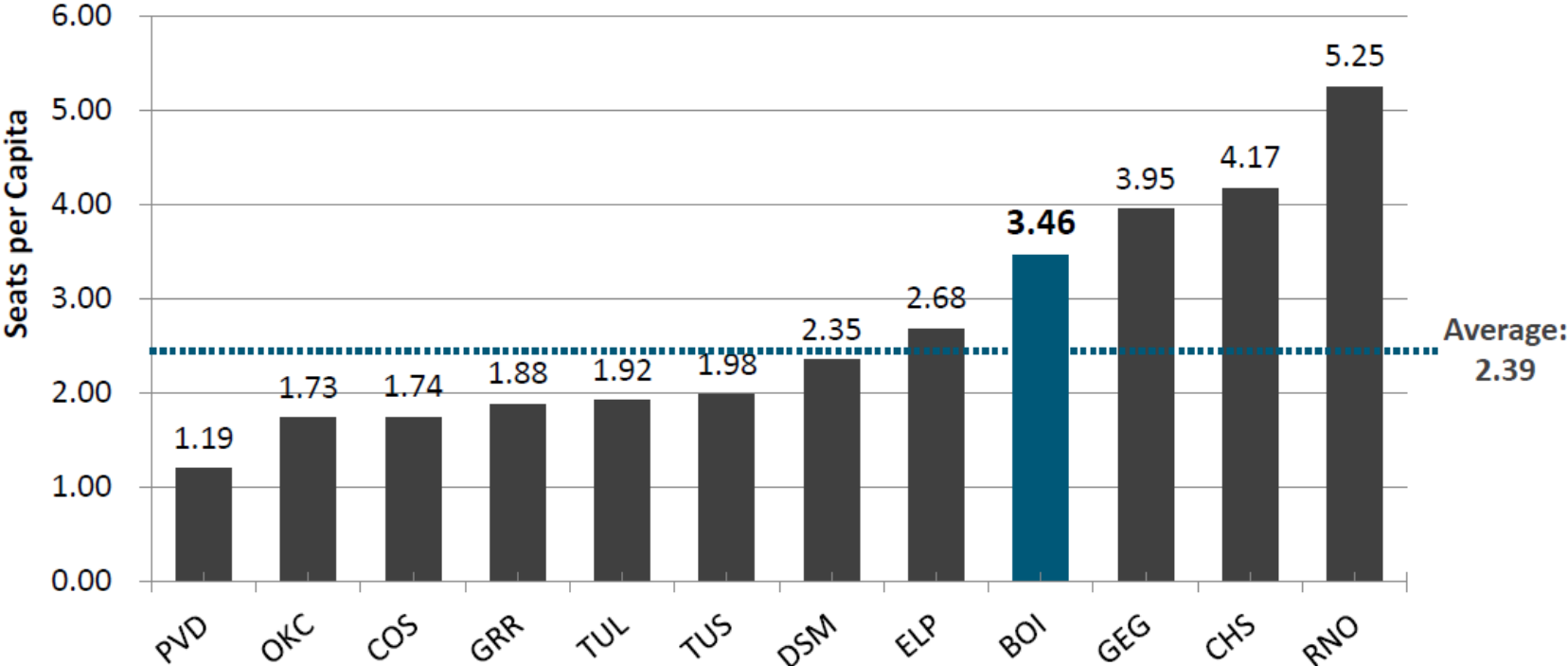

Origination/Destination Passenger and Airfare Comparison

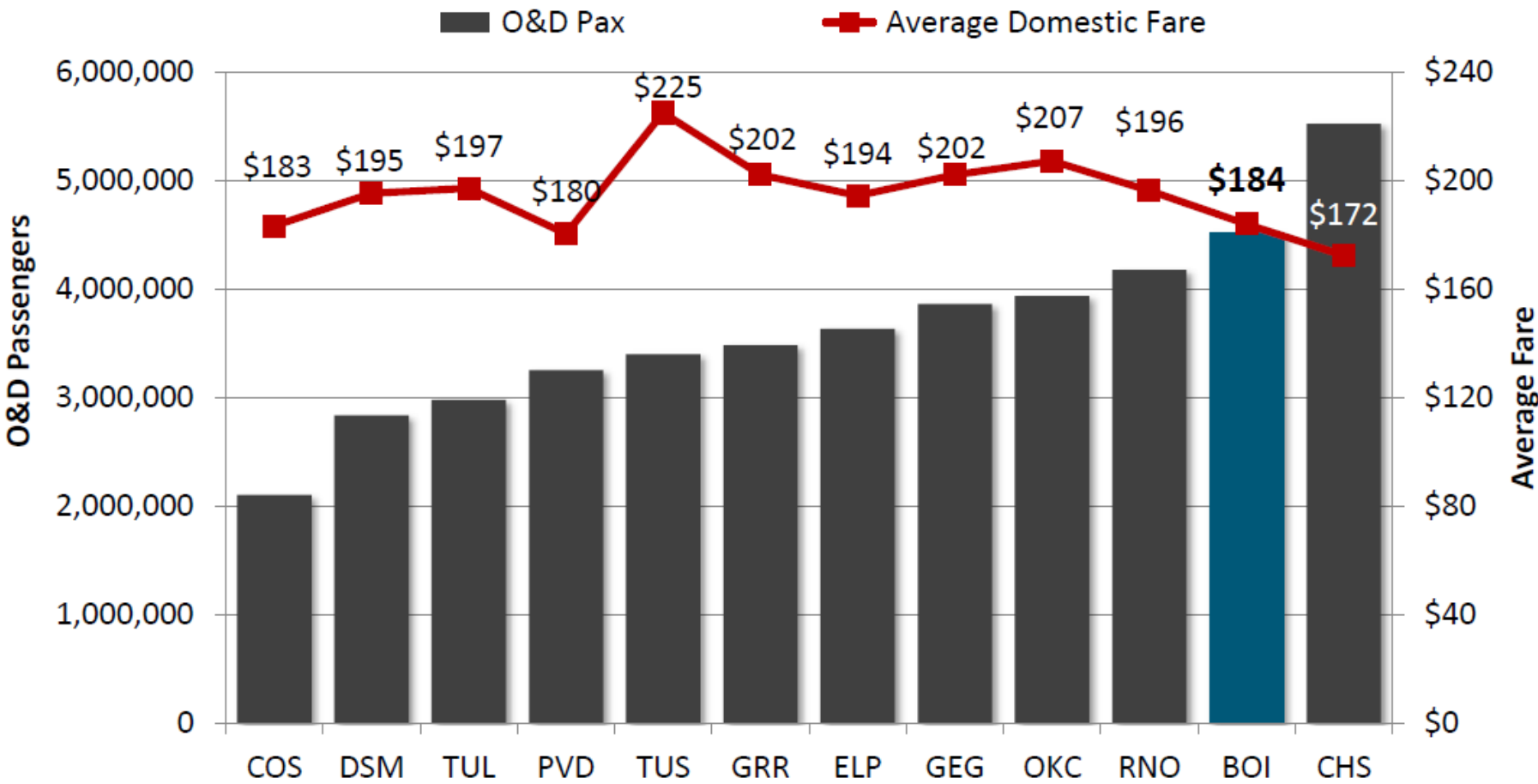

BOI ranked 2nd in O&D passengers and had the 4th lowest average domestic fare

Year-Over-Year Comparisons

Airport	2023 MSA Population	YE Q2 2023			YOY Change		
		# of Nonstop Destinations	O&D Pax	Seats	# of Nonstop Destinations	O&D Pax	Seats
Reno, NV	510,337	31	4,174,677	5,354,888	(4)	5%	3%
Spokane, WA	603,137	21	3,859,702	4,765,445	(1)	10%	7%
Des Moines, IA	732,565	31	2,834,149	3,444,818	(1)	12%	9%
Colorado Springs, CO	780,903	16	2,101,592	2,720,784	3	2%	(3%)
Boise, ID	820,134	26	4,519,414	5,672,736	(4)	13%	9%
Charleston, SC	835,740	49	5,522,652	6,972,025	0	14%	10%
El Paso, TX	888,155	15	3,633,771	4,761,370	(2)	12%	19%
Tulsa, OK	1,037,114	26	2,977,695	3,977,477	1	15%	19%
Tucson, AZ	1,071,487	21	3,397,692	4,234,470	1	10%	12%
Grand Rapids, MI	1,105,402	33	3,481,491	4,155,666	(2)	7%	6%
Oklahoma City, OK	1,468,034	25	3,936,824	5,075,454	(1)	10%	11%
Providence, RI	1,682,286	32	3,252,574	4,019,020	4	14%	17%

BOI had the 4th highest percentage passenger increase and tied for the 7th highest percentage seat increase of the comparison markets.

The logo features a stylized graphic of three curved, overlapping shapes in shades of blue and green, resembling a wing or a stylized letter 'B'.

Boise Airport

www.iflyboise.com